

LEGEND

- PROPERTY LINE
HIGH POINT (H.P.)
DIRECTION OF FLOW
PROPOSED FINISHED FLOOR ELEVATION
PROPOSED PAVEMENT ELEVATION
PROPOSED SIDEWALK ELEVATION

SITWORKS NOTES:

- CONTRACTOR SHALL FIELD VERIFY LOCATION AND ELEVATION OF ALL EXISTING UTILITIES PRIOR TO CONSTRUCTION OF PROPOSED FACILITIES. NOTIFY ENGINEER IMMEDIATELY OF ANY DISCREPANCIES.
- CONTRACTOR SHALL NOTIFY THE APPROPRIATE UTILITY COMPANY 48 HOURS PRIOR TO EXCAVATING NEAR THEIR UTILITY.
- CONTRACTOR SHALL TAKE ALL DUE PRECAUTIONS TO PROTECT EXISTING FACILITIES FROM DAMAGE. ANY DAMAGE TO EXISTING FACILITIES INCURRED AS A RESULT OF CONSTRUCTION OPERATIONS WILL BE REPAIRED BY THE CONTRACTOR AT HIS OWN EXPENSE.
- CONTRACTOR SHALL TAKE EXTRA CARE TO PROTECT TREES IN AREAS ADJACENT TO CONSTRUCTION.
- CONTRACTOR SHALL CONFIRM NO CONFLICTS BETWEEN EXISTING AND PROPOSED DRY/WET UTILITIES IN PUBLIC R.O.W., BEFORE STARTING SITE WORK CONSTRUCTION.

CONSTRUCTION NOTE:

CONTRACTOR SHALL CONFIRM NO CONFLICTS BETWEEN EXISTING AND PROPOSED DRY/WET UTILITIES IN PUBLIC R.O.W., BEFORE STARTING SITE WORK CONSTRUCTION.

CONTRACTOR SHALL HYDROMULCH ALL NEWLY GRADED AREAS AND EXPOSED SOILS UPON PAVING COMPLETION.

EXCESS SOIL MATERIAL IS THE RESPONSIBILITY OF THE CONTRACTOR & IS TO BE DISPOSED OFFSITE RESPONSIBLY AT NO SEPARATE PAY.

FLOOD PLAIN DATA

ALL OF THIS PROPERTY LIES WITHIN ZONE "X-SHADED" FLOODPLAIN PER THE FLOOD INSURANCE RATE MAP, COMMUNITY PANEL NO. 3720468600-K, WHICH BEARS AN EFFECTIVE DATE JULY 07 2014.

ZONE "X-SHADED" DENOTES AREA OUTSIDE THE 100 YEAR FLOODPLAIN.

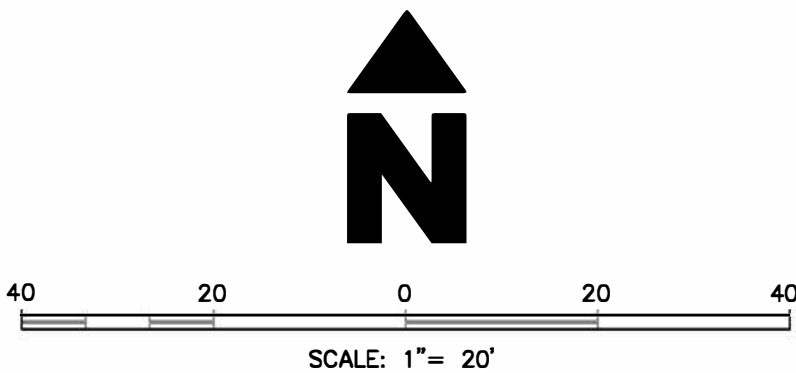

MULTIUSE DEVELOPMENT
IN GREENVILLE, NC
ADJ. TO 1800 E FIRE
TOWER RD GREENVILLE, NC 27858

SITE GRADING
AND DRAINAGE
PLAN

DESIGNED BY:
DWN BY:
CHK BY:

SHEET
REFERENCE:

C.01

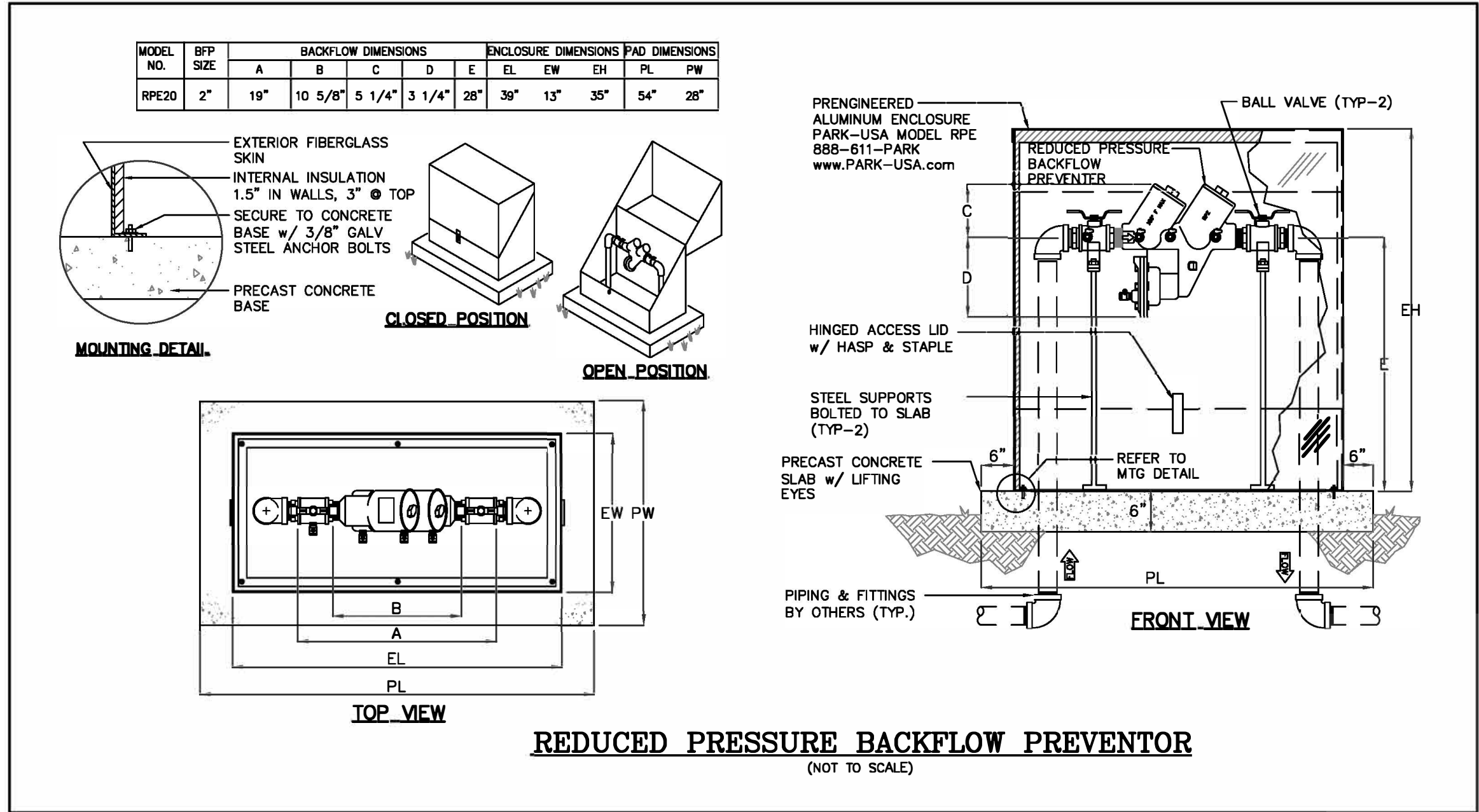

GENERAL NOTES: SITEWORK

A. EXISTING UTILITIES, FACILITIES & TREES

CONTRACTOR SHALL FIELD VERIFY LOCATION AND ELEVATION OF ALL EXISTING UTILITIES PRIOR TO CONSTRUCTION OF PROPOSED FACILITIES. NOTIFY ENGINEER IMMEDIATELY OF ANY DISCREPANCIES.

CONTRACTOR SHALL NOTIFY THE APPROPRIATE UTILITY COMPANY 48 HOURS PRIOR TO EXCAVATING NEAR THEIR UTILITY.

CONTRACTOR SHALL TAKE ALL DUE PRECAUTIONS TO PROTECT EXISTING FACILITIES FROM DAMAGE. ANY DAMAGE TO EXISTING FACILITIES INCURRED AS A RESULT OF CONSTRUCTION OPERATIONS WILL BE REPAIRED BY THE CONTRACTOR AT HIS OWN EXPENSE.

CONTRACTOR SHALL TAKE EXTRA CARE TO PROTECT TREES IN AREAS ADJACENT TO CONSTRUCTION.

B. DOMESTIC WATER SYSTEM

ALL WATER LINE MAINS SIZES 1 THRU 3 INCH SHALL BE PVC SCH 40.

WATER LINE SHALL BE CONSTRUCTED AND TESTED IN ACCORDANCE WITH AUTHORITY SPECIFICATION FOR WATER MAIN CONSTRUCTION AS CURRENTLY AMENDED.

WATER LINE SHALL HAVE BANK SAND BEDDING AND BACKFILL.

PROVIDE THRUST BLOCKING ACCORDING TO AUTHORITY STANDARDS SPECIFICATIONS.

PROVIDE A MINIMUM 6-INCHES OF CLEARANCE AT STORM SEWER AND WATER LINE CROSSING.

C. SANITARY SEWER SYSTEM

POLY-VINYL-CHLORIDE (PVC SDR 26) PIPE SHALL CONFIRM TO ASTM SPECIFICATIONS D3034 AND BE INSTALLED ACCORDING TO ASTM D2321.

ALL SANITARY SEWER SERVICE LINES SHALL BE CONSTRUCTED TO TRUE ALIGNMENT AND GRADE. WARPED AND SAGGING LINES WILL NOT BE PERMITTED.

BUILDING TIE-ON CONNECTION WILL BE MADE DIRECTLY TO THE STUB-OUT FROM THE BUILDING PLUMBING AT THE FOUNDATION ON ALL WASTES OUTLETS.

WATER-TIGHT ADAPTERS OF A TYPE COMPATIBLE WITH THE MATERIALS BEING JOINED WILL BE USED AT THE POINT OF CONNECTION OF THE SERVICE LINE TO THE BUILDING PLUMBING. NO CEMENT GROUT MATERIALS ARE PERMITTED.

NO BENDS OR TURNS AT ANY POINT WILL BE GREATER THAN 45 DEGREES.

CLEANOUT WILL BE MADE WITH AIRTIGHT MECHANICAL PLUG.

THE PHYSICAL CONNECTION TO THE AUTHORITY'S SEWER MAIN WILL BE MADE BY USE OF AN ADAPTER OF A TYPE COMPATIBLE WITH MATERIALS BEING JOINED. THE CONNECTION SHALL BE WATERTIGHT. NO CEMENT GROUT MATERIALS ARE PERMITTED.

BACKFILLING OF SERVICE LINES TRENCH MUST BE ACCOMPLISHED WITHIN TWENTY-FOUR (24) HOURS OF INSPECTION AND APPROVAL. NO DEBRIS WILL BE PERMITTED IN THE TRENCH.

SANITARY SEWER CLEANOUTS: ENSURE SANITARY SEWER CLEANOUTS ARE INSTALLED: EVERY 100 FEET ALONG HORIZONTAL PIPING, AT ALL DIRECTION CHANGES GREATER THAN 45 DEGREES. ACCORDING TO FBC-PLUMBING 708.1.1.

HORIZONTAL SEPARATION: MAINTAIN A MINIMUM 5 FEET OF HORIZONTAL DISTANCE BETWEEN THE WATER SUPPLY AND SEWER LINES.

VERTICAL SEPARATION (IF CROSSING): THE WATER SUPPLY LINE MUST BE INSTALLED 12 INCHES ABOVE THE SEWER LINE. IF THIS SEPARATION IS NOT ACHIEVABLE, ENCASE THE SEWER PIPE IN CONCRETE.

LEGEND

- PROPERTY LINE
- WASTEWATER
- WATER LINE

SITEWORKS NOTES:

- CONTRACTOR SHALL FIELD VERIFY LOCATION AND ELEVATION OF ALL EXISTING UTILITIES PRIOR TO CONSTRUCTION OF PROPOSED FACILITIES. NOTIFY ENGINEER IMMEDIATELY OF ANY DISCREPANCIES.
- CONTRACTOR SHALL NOTIFY THE APPROPRIATE UTILITY COMPANY 48 HOURS PRIOR TO EXCAVATING NEAR THEIR UTILITY.
- CONTRACTOR SHALL TAKE ALL DUE PRECAUTIONS TO PROTECT EXISTING FACILITIES FROM DAMAGE. ANY DAMAGE TO EXISTING FACILITIES INCURRED AS A RESULT OF CONSTRUCTION OPERATIONS WILL BE REPAIRED BY THE CONTRACTOR AT HIS OWN EXPENSE.
- CONTRACTOR SHALL TAKE EXTRA CARE TO PROTECT TREES IN AREAS ADJACENT TO CONSTRUCTION.
- CONTRACTOR SHALL CONFIRM NO CONFLICTS BETWEEN EXISTING AND PROPOSED DRY/WET UTILITIES IN PUBLIC R.O.W., BEFORE STARTING SITE WORK CONSTRUCTION.

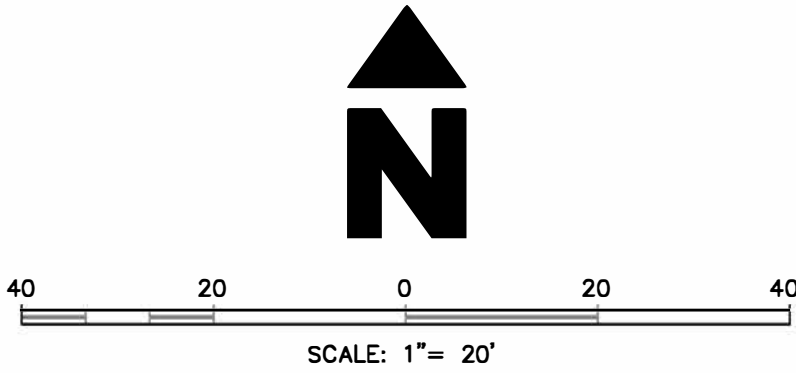
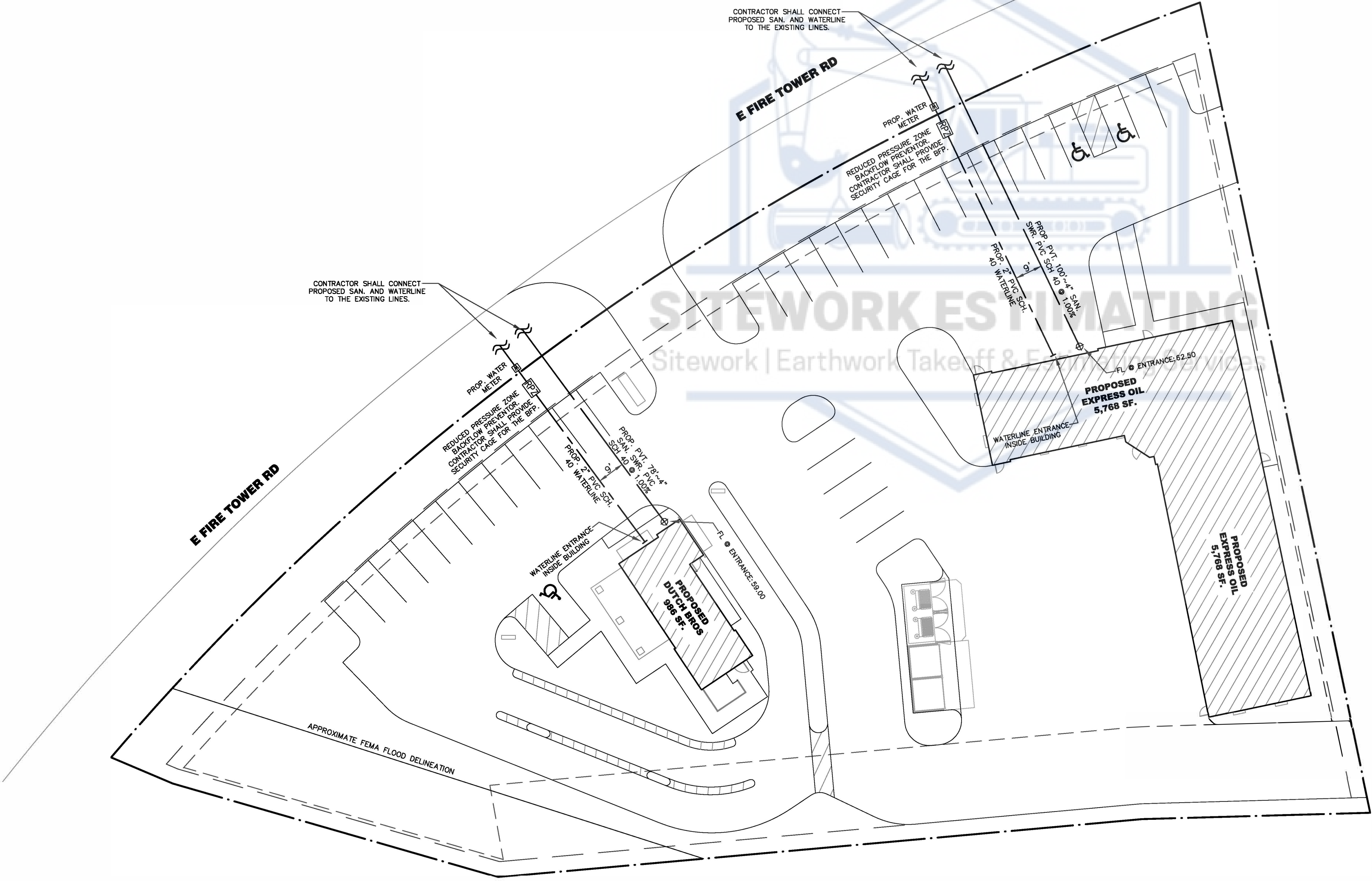

MULTIUSE DEVELOPMENT
IN GREENVILLE, NC

ADJ. TO 1800 E FIRE
TOWER RD GREENVILLE, NC 27858

SITE UTILITIES
PLAN

DESIGNED BY:

DWN BY:

CHK BY:

SHEET
REFERENCE:

C.02